

## Montage- und Gebrauchsanweisung / Operating and assembly instructions Instrukcja montażu i użytkowania

Lehnen Funktion NIL\_0L2D ; NIL\_0P2D

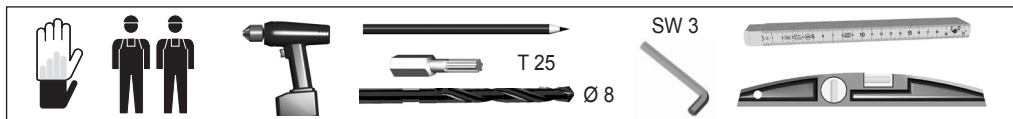

### 1. Stückliste / Parts list / Wykaz części

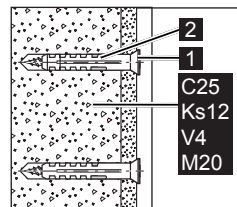
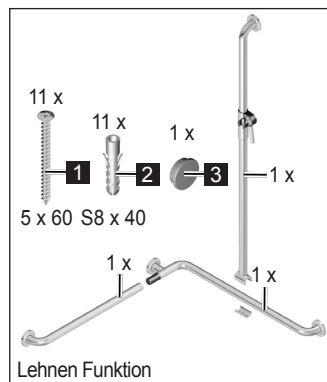
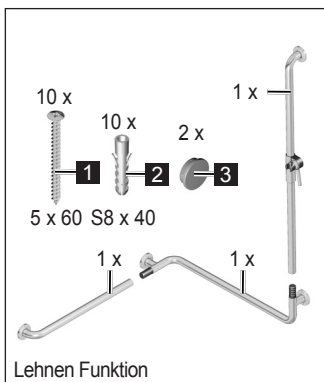
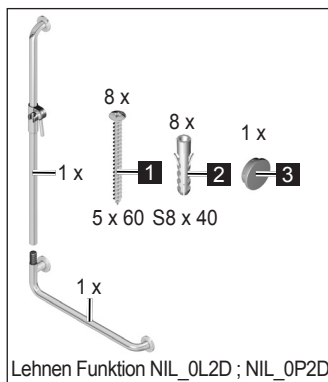
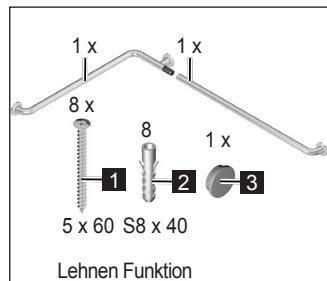
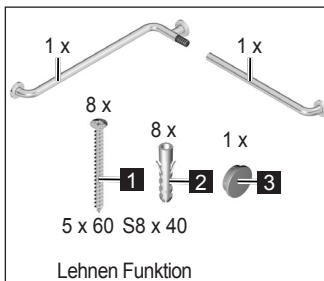
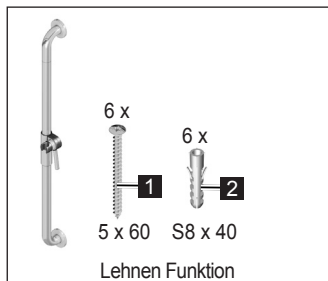

Management System  
ISO 9001:2015  
www.tuv.com  
ID: 3105032529



## 2. Planungshilfe / Planning aids / wskazówki montażowe



## 3. Montage / Installation mounting / Montaż

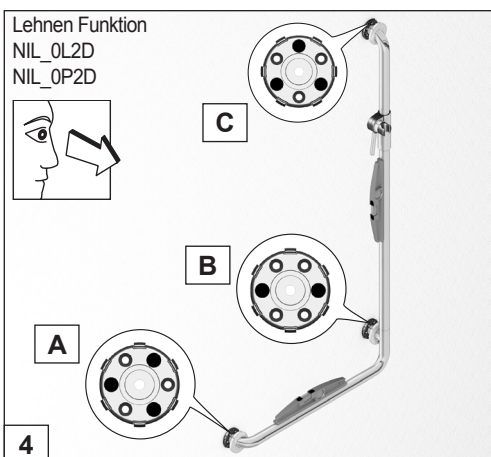
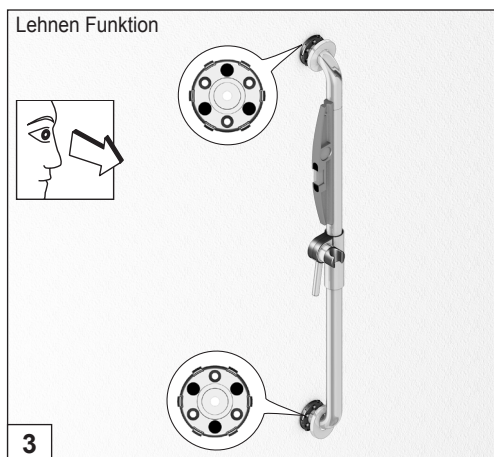
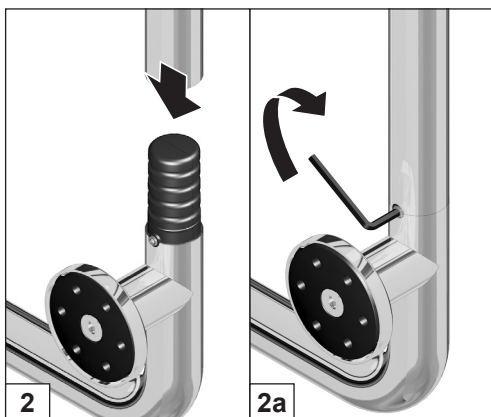
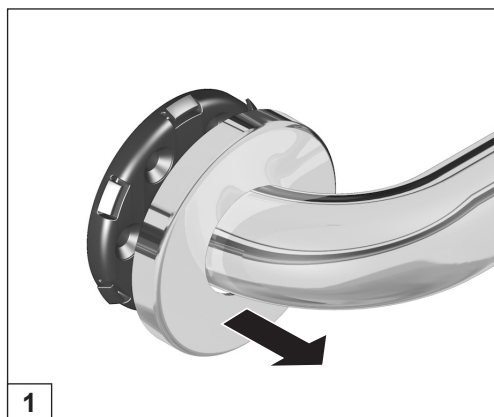

Lehnen Funktion

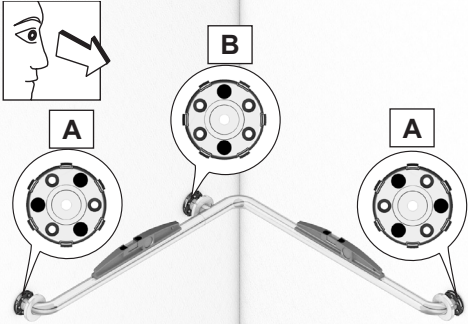

5

Lehnen Funktion

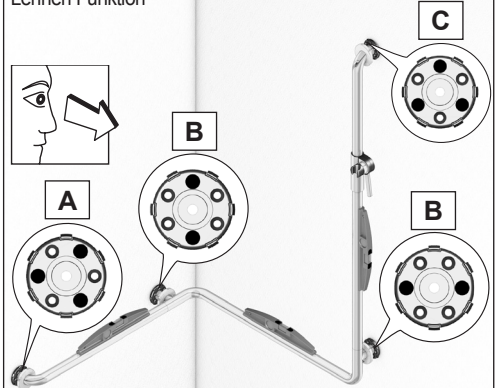

6

Lehnen Funktion

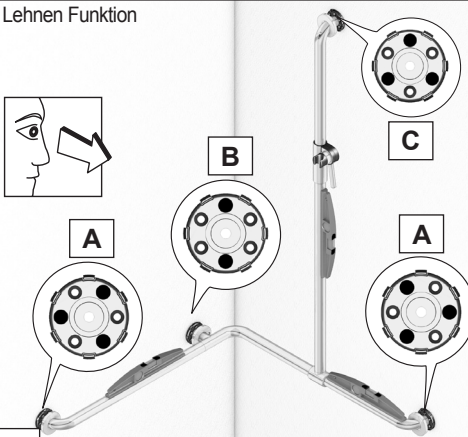

7

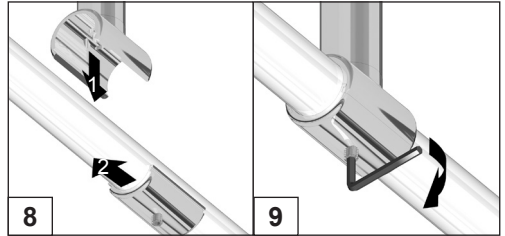

8

9

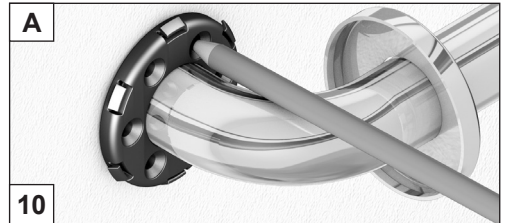

10

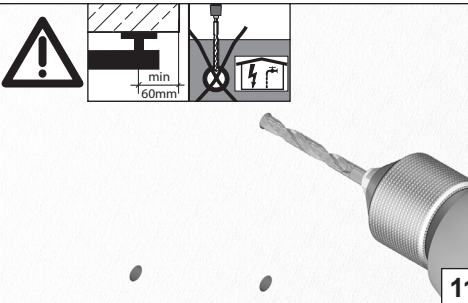

11

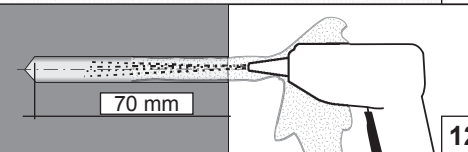

12

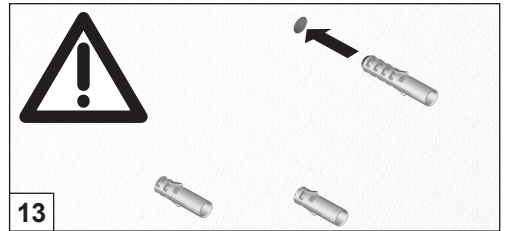

13

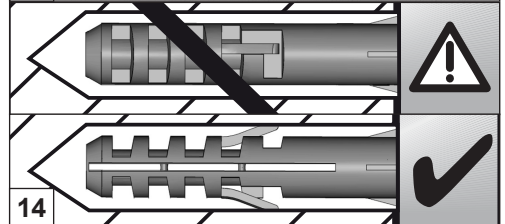

14

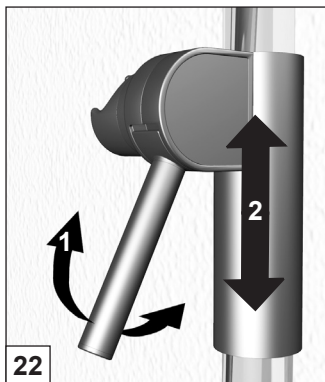
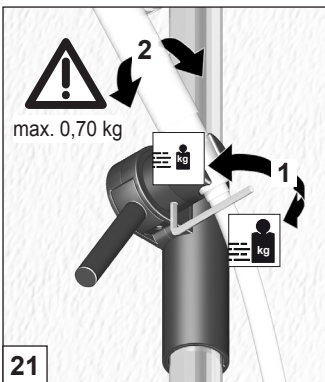
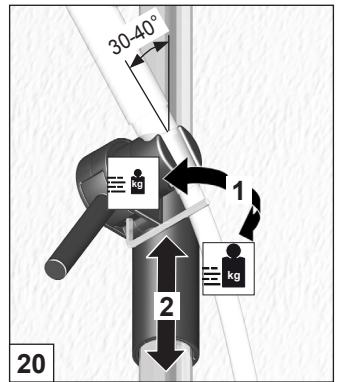
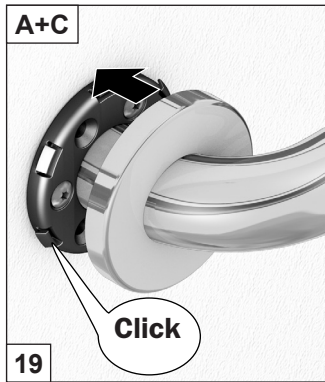
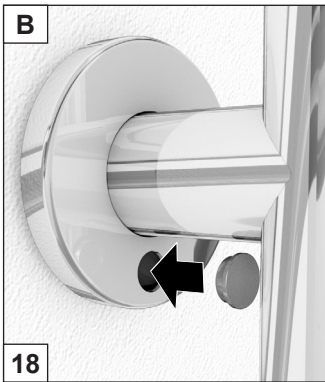
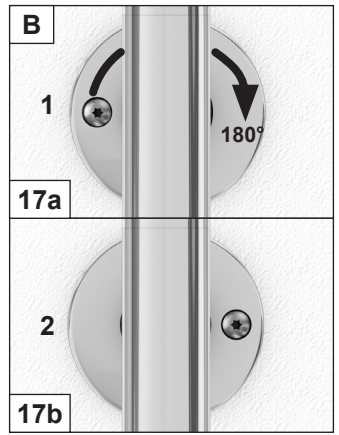
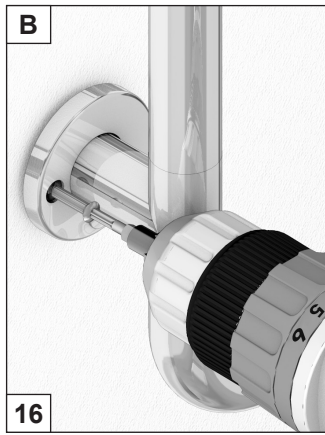
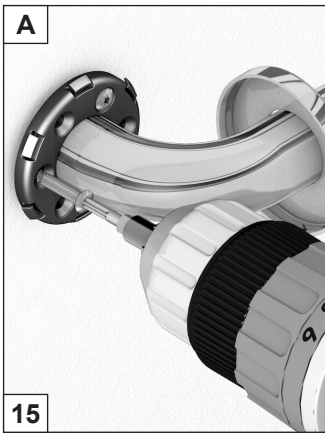

#### 4. Pflege und Reinigung / Cleaning and care / Konserwacja i czyszczenie



Rev. 4 / 24.07.2023

Lehnen GmbH / Kleiner Straße 10 / 54472 Longkamp / Germany / Telefon: 06531 - 500 57-0 / Fax: 06531 - 500 57-22 / www.lehnen.de